

Bethesda Fun Fact

In 1978 Bethesda had a \$3,500,000 expansion program with the building of Pleasant View and remodeling of Heritage Center.

The new Pleasant View building was erected on land at 9th and Willmar Avenue SE, and housed the 120 bed skilled nursing care center. There were 80 private rooms and 20 double rooms. The building featured many luxuries such as air-conditioning with individual thermostats and humidity controls.

Pleasant View was one of the first of its kind featuring a town structure style which included: chapels, activity areas, physical therapy rooms, hair care, barber shop, meeting rooms, offices, emergency power plants, staff dining and locker rooms, a coffee shop, an indoor garage near an elevator for loading residents indoors to take to doctors, dentists, podiatrists, and hospital.

Q G P C J T Z O A D E B M Z T P C P L S
W Y I K I O W T N E D R Q M T U B L K X
M C E V J W Q J H G A R A G E C U E F A
C F B I T P K G X E X H C I E Y I A L U
L H C E B H Z C O Q R C I C D V L S K D
A F A W L N T P H F V A O E D Q D A C R
Q S C P L B O S F R X J P F R K I N I R
N D I Z E Q R N Z S G N L Y F Y N T U Y
N F U H O L M O P J J U R H N E G F F S
I O Q Q O M E G I G F R M Q P E E U X R
J H M A U W M D R S E S O T G J Q P I C
K R H J L D Q Z E V K I N U O C S T E L
X W I L L M A R M Q J N E T V W O D L N
H H F D H N V K O D V G O I T E C A E N
K U C B G Z M U D B A R B E R D F S V O
L D K J M Q S V E S X D Z D M W M F A S
O V V J U H D Q L V J I D R Y E N Z T F
A Z Z Z S B Z B I M F V B U T S T E O N
A I Q X F J X A N K E Q E C U K O G R S
I A N E P I I O G W J O K H F N W N C K

REMODELING

PLEASANT

BUILDING

ELEVATOR

WILLMAR

THERAPY

NURSING

CHAPEL

BARBER

GARAGE

COFFEE

VIEW

Bethesda Fun Fact

Bethesda's Pleasant View welcomed more than 1,600 visitors at the open house which was held on Sunday, January 7, 1979.

The 120 bed skilled nursing home was nearly full upon opening. During the transition amongst the three homes, Heritage Center was reduced from 166 beds to 78 intermediate beds and 57 board and care beds (approximately 40 of which were available during the transition).

The new home cost nearly \$4,000,000 and encompassed every possible convenience and comfort for the residents that were available at the time. It continues to stand as a landmark in the community 43 years later.

The dedication for Pleasant View was held on June 10, 1979 to which the public was invited. The Rev. John M. Mason, former director of the Department of Services for the Aging of the ALC gave the Dedicatory Address. He was introduced by John Larson, a member of the Board.

The Bethesda Auxiliary, under the direction of Mrs. Jeanette Bogue, provided and served refreshments to those in attendance.

Bethesda Pleasant View
Willmar, MN
1979-Present

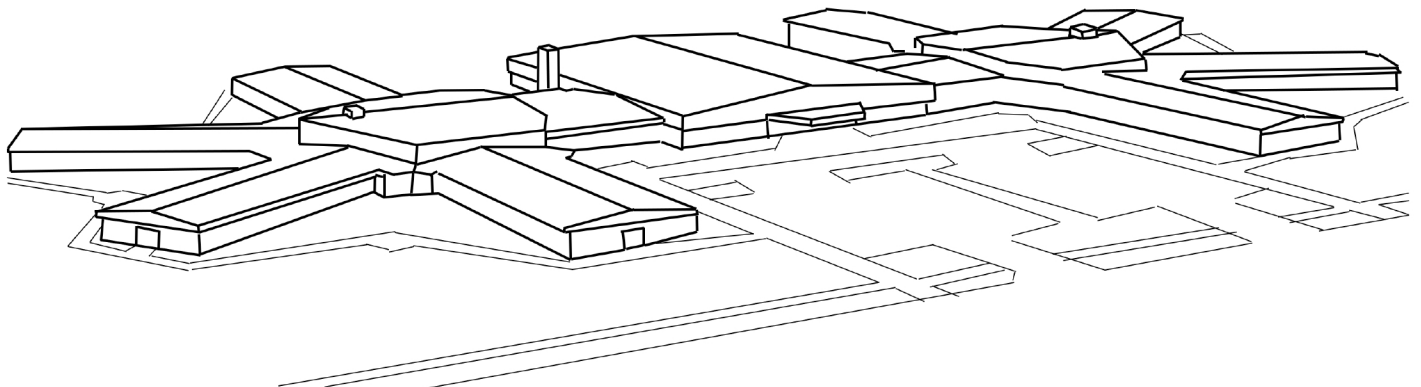

Bethesda Fun Fact

In June of 2009, The Willmar City Council approved to issue \$8 million in nursing home revenue bonds to finance an addition at Bethesda. The expansion would include a nearly 30,000 square-foot adult day services center, a warm water therapeutic pool, space for exercise and physical, occupational, and speech therapy, spa area, and home care offices.

Bethesda broke ground for the expansion on Friday, August 21, 2009. The construction took place in three phases over three years. In the fall of 2009, a two-level addition for the adult day services program would begin construction and was completed in late summer 2010. The pool area would be the second phase which started in 2011. The project's final phase would be adding additional resident rooms, dining areas, and expanding the short-term rehabilitation program.

Bethesda's board of directors had noticed that there was a significant paradigm shift over the previous decade. Sharon Tack, development director at the time, was quoted as saying, "At one time, when people entered a nursing home, they usually stayed there for the rest of their lives. Many people now go into a nursing home for only a short time - to receive physical therapy after knee replacement surgery, for instance - and then return to their own home."

This shift has dramatically affected how Bethesda supports the community. This change lead to a significant focus on short-term rehabilitation and therapy services. "The idea is to keep people healthy and at home, which is where they prefer to be," stated Doug Dewane, Bethesda's Chief Executive.

Bethesda purchased the equipment for the wellness center from Helsinki University Research, a Finland company whose designs include machines tailored with older exercisers in mind. Computerized touchscreen programs allow for easy-to-use programs that can be customized to each individual's needs and are accessible for those with mobility issues and those that need a wheelchair.

Down:

1. the construction of the addition took place over this many years.
2. The expansion included space for an adult day services center, a warm water _____, space for exercise and physical, occupational, and speech therapy, spa area, and home care offices.
3. Bethesda purchased equipment for the wellness center from Helsinki _____ Research.

Across:

4. Bethesda's focus on short-term rehabilitation and therapy helps people healthy and able to stay at _____.
5. The exercise equipment is able to be _____ to individual's needs.
6. This city council approved \$8 million in nursing home revenue bonds to finance an addition at Bethesda Pleasant View.
7. Bethesda's wellness center focuses on machines and programs that are accessible for those with _____ issues and those that need a wheelchair.

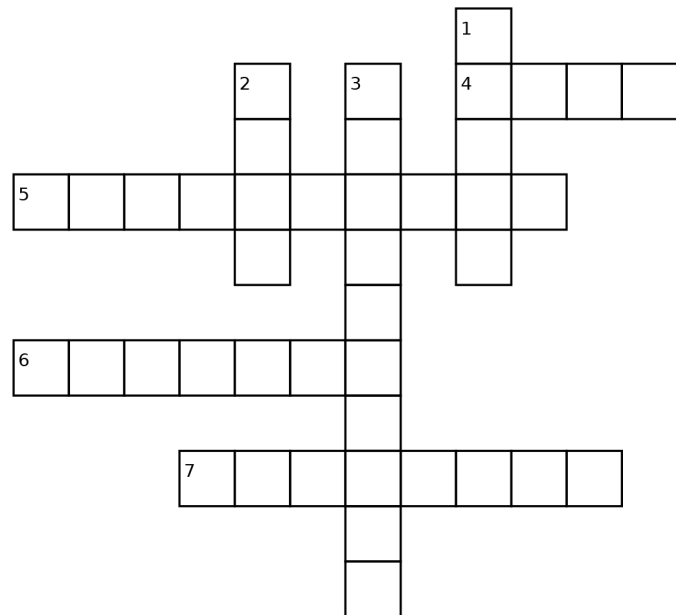

Word Bank:

Willmar
University

Pool
Customized

Three
Mobility

Home

Bethesda Fun Fact

As the aging population grows, Bethesda continues to pivot to fill the community's needs.

In October 2014, Bethesda broke ground on an expansion to provide more housing with a two-story skilled nursing facility. After the addition was completed in September of 2016, the residents of Bethesda's Heritage Center would move to the updated state-of-the-art Pleasant View skilled-nursing center.

The redevelopment involved changing the paradigm of how services were provided: 36-bed short-term stay area, more options, more flexibility, an environment that is more home, and an emphasis on social connections.

Even now, in 2022, Bethesda continues to expand and adjust to the community's needs. At this time in history, Bethesda's community includes opportunities for independent, assisted, enhanced, and memory care options on our campuses in Willmar, Olivia, or New London. Each campus is unique in the services that are offered.

Word Scramble

OTIONAUPLP

TOPVI

TIYMNOCU

BEAHSTED

NINRGSU

NTSERIED

TNEASAPL EWVI

LAOISC

YOSIHRT

EPNDIEDNNAT

EDSTSSIA

HENDCAEN

MMREYO AREC

LWMARIL

LAOIIV

EWN NDOLON

Word Bank:

ASSISTED
BETHESDA
COMMUNITY
ENHANCED
HISTORY
INDEPENDANT
MEMORY CARE
NEW LONDON
NURSING
OLIVIA
PIVOT
PLEASANT VIEW
POPULATION
RESIDENT
SOCIAL
WILLMAR